

**Plan Care**

**35980010037 Tip-up seat**

**PRODUCT**



**PRODUCT ATTRIBUTES**

tip up, wall mounted

**SURFACE**

chrome-plated/dark grey (RAL 7021)

**DRAWING**

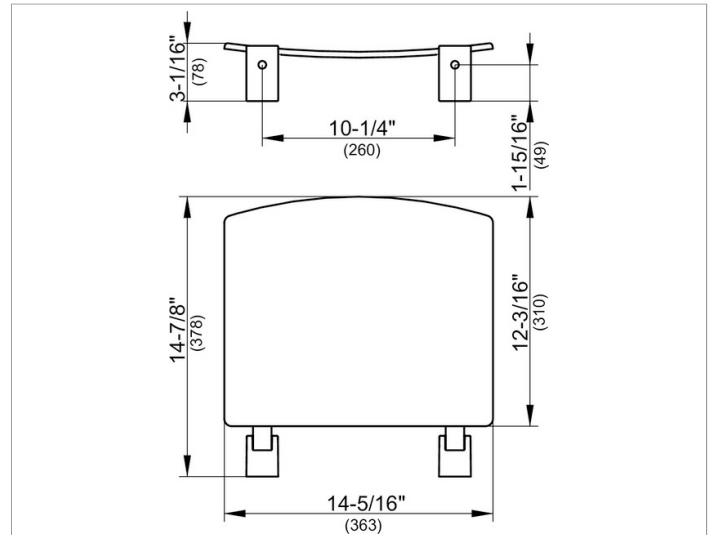

**SPECIFICATIONS**

KEUCO PLAN CARE Tip-up seat 35980010037  
chrome plated with dark-grey (RAL 7021) seat  
wall mounted  
maximum load is 253 Lb

This product is no stronger than the fixings and wall structure to which it is attached and it must be firmly secured to function as intended!

**Warranty:** KEUCO products are covered by a 5-year manufacturer's warranty, in effect from the date of purchase. During this time, proven product defects will be remedied free of charge. Warranty claims must be filed in writing, including a detailed description of the defect immediately after a defect has occurred. For a copy of our detailed product warranty policy, please contact us at [office-usa@keuco.com](mailto:office-usa@keuco.com).

**Installation:** KEUCO products must be installed by a qualified professional in accordance with the respective installation guidelines and any applicable federal / local building codes and regulations.