

Collection Moll
12762010000 Toilet paper holder

PRODUCT

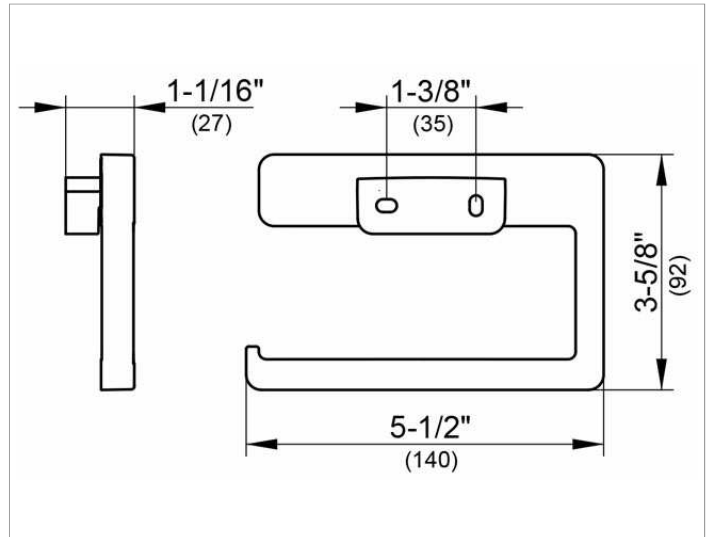

DRAWING



SURFACE

chrome-plated

SPECIFICATIONS

KEUCO COLLECTION MOLL 12762010000 toilet paper holder , open form, chrome-plated
 toilet paper holder in an esthetic design, open form, holder with slightly rounded edges
 Suitable for 3-15/16" wide toilet rolls
 Width 5-1/2", height 3-5/8", Projection 1-1/16"
 The toilet paper holder is fitted with 2 hidden fixing points incl. corrosion-free mounting material

Warranty: KEUCO products are covered by a 5-year manufacturer's warranty, in effect from the date of purchase. During this time, proven product defects will be remedied free of charge. Warranty claims must be filed in writing, including a detailed description of the defect immediately after a defect has occurred. For a copy of our detailed product warranty policy, please contact us at office-usa@keuco.com.
Installation: KEUCO products must be installed by a qualified professional in accordance with the respective installation guidelines and any applicable federal / local building codes and regulations.